

10	11	12	13	14	15	16	17	18	IN	OUT	TOT	HCP	NET
434	539	206	381	379	565	425	191	400	3520	3551	7071		
385	525	188	372	342	520	388	150	360	3230	3270	6500		
367	491	180	360	329	507	373	137	346	3090	3115	6205		
6	4	14	16	10	2	8	18	12					
4	5	3	4	4	5	4	3	4	36	36	72		
308	435	170	323	267	433	314	129	281	2660	2807	5467		
5	1	11	7	17	3	9	15	13					

Attest: _____ Date: _____



Hole	Rating/Slope	1	2	3	4	5	6	7	8	9	OUT
<i>Black</i>	72.8/123	520	372	205	427	465	378	190	477	517	3551
<i>Blue</i>	70.5/121	500	360	190	387	420	364	175	369	505	3270
<i>White</i>	m 69.2/118 w 74.8/125	472	346	170	382	397	348	156	356	488	3115
<i>Men's Handicap</i>		7	13	11	1	3	9	17	15	5	
<i>Par</i>		5	4	3	4	4	4	3	4	5	36
<i>Red</i>	70.7/118	428	295	130	353	330	332	147	337	455	2807
<i>Ladies' Handicap</i>		4	12	18	8	6	14	16	10	2	

Scorer:



Etiquette

- All golfers must check in with the golf shop.
- Fivesomes with professional's approval only.
- Avoid slow play. Allow faster players through.
- Rake bunkers.
- Repair ball marks.
- Replace divots.
- Keep carts 30 feet away from tees and greens.
- Use cart paths where available.
- Pace of play: 2 hours per 9 holes.

© Golf ScoreCards, Inc.
3/2017 1-800-238-7267

Play USGA Rules

1. Out of Bounds: White stakes on No.'s 2, 3, 4, 5, 6, 7, 8, 9, 11, 12, 13, 14, 15. Any ball that crosses a residential road is considered out of bounds.
2. Lateral Hazards: Red stakes on No.'s 1, 5, 6, 7, 9, 10, 17.
3. Free drop from all staked trees, cart paths, maintenance roads and flower beds.



PGA
Max Hadenfeldt
Director of Golf

GCSAA
Jason Wilcox
Superintendent

DIE CUT

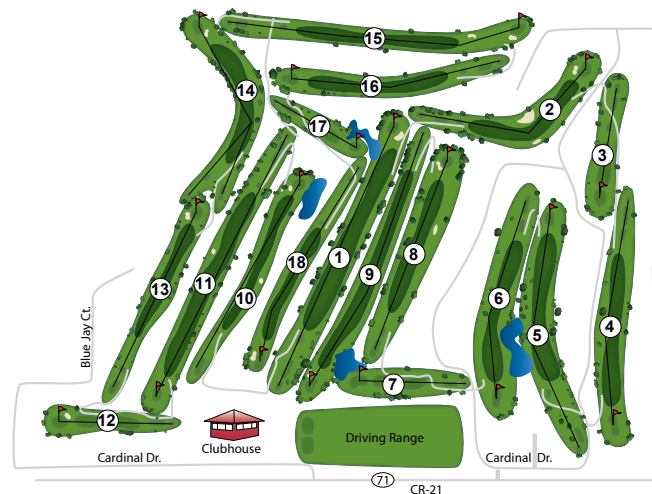

5014 Ave. I, Scottsbluff, NE 69361
(308) 635-1844 • www.scottsbluffcc.com